



# MALAYAN TOWAGE & SALVAGE CORPORATION

16<sup>th</sup> Floor, Equitable Bank Tower, 8751 Paseo de Roxas, Salcedo Village, Makati City Philippines  
Mailing Address: C.C.P.O. Box 2983, Makati City Philippines • Telephones : 885-7740 (24 Hours FAX) • 817-6176 (Operation Dept-Direct Line)  
Telefax Nos.: (632) 816-1128 • 816-2293 • (632) 810-0785



## M.T. "FITIAL"

UNITED STATES COAST GUARD  
Official Number 979746

Length _____	28.50 Meters
Breadth _____	8.80 Meters
Depth _____	3.50 Meters
Gross Tonnage _____	223
Net Tonnage _____	66
Speed _____	13 Knots
Bollard Pull _____	52 Tons (Ahead)
<b>Main Engine:</b> Niigata Diesel _____	2 Sets
<b>Propeller:</b> Niigata Z-Type Propulsion System (Z-Peller ZP-2) in Kort Nozzle _____	2 Sets

# M.T. "FITIAL"

## General Arrangement Plan

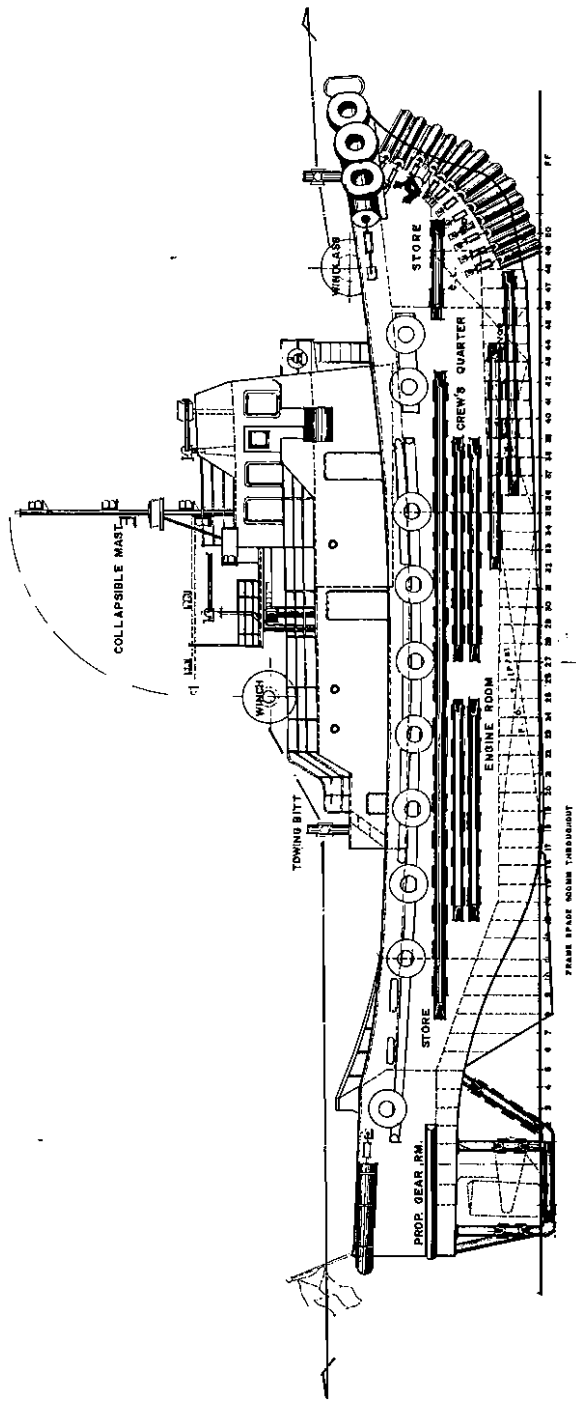

OUTBOARD PROFILE

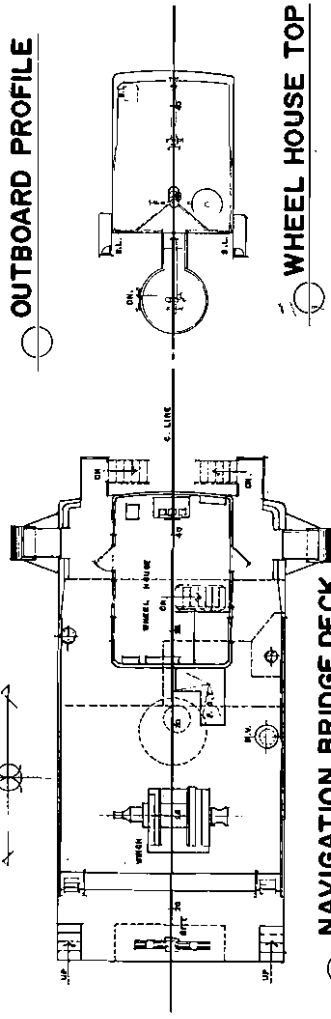

NAVIGATION BRIDGE DECK

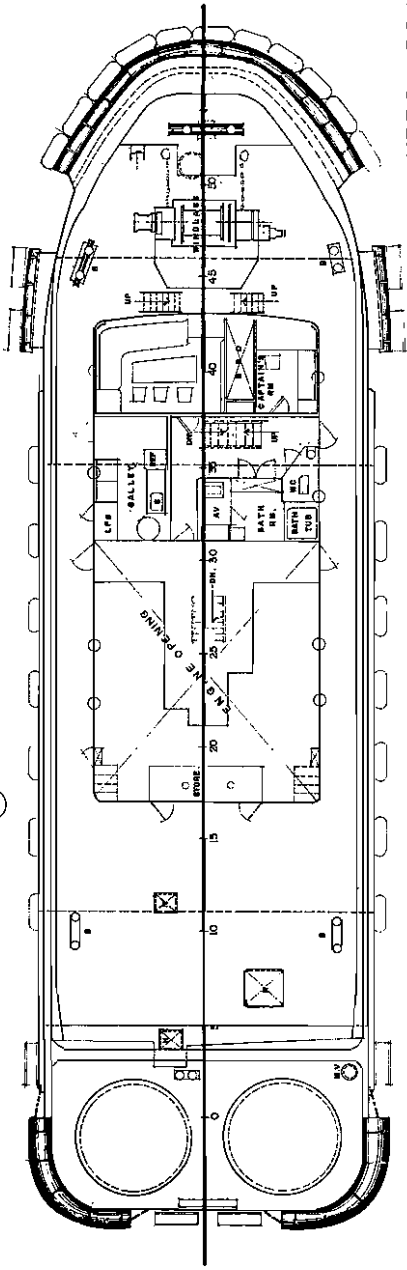

UPPER DECK

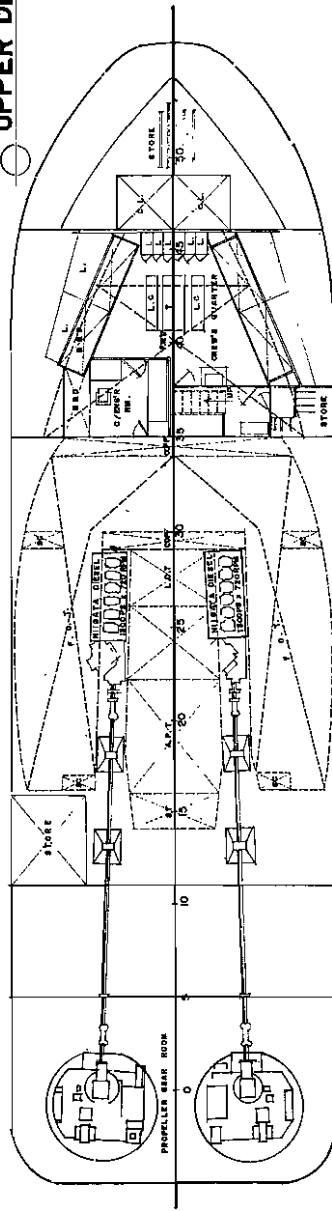

HOLD PLAN